



WE'RE ON THE MOVE!

**HELP US BUILD OUR VISION &
BUILD YOUR BRAND**

Hobe Sound Centre Building
8958 & 8962 Bridge Road,
Hobe Sound 33455
PO Box 1507

BUILD YOUR BRAND AT THE CHAMBER...

Invest Now & Countdown to Completion!

The Hobe Sound Chamber of Commerce will occupy it's new, larger space (1800 sq. ft.) by Nov. 1, 2017. With a state-of-the-art seminar & board room and a functional visitor center & gift shop, members will have new ways to stand-out and market themselves.

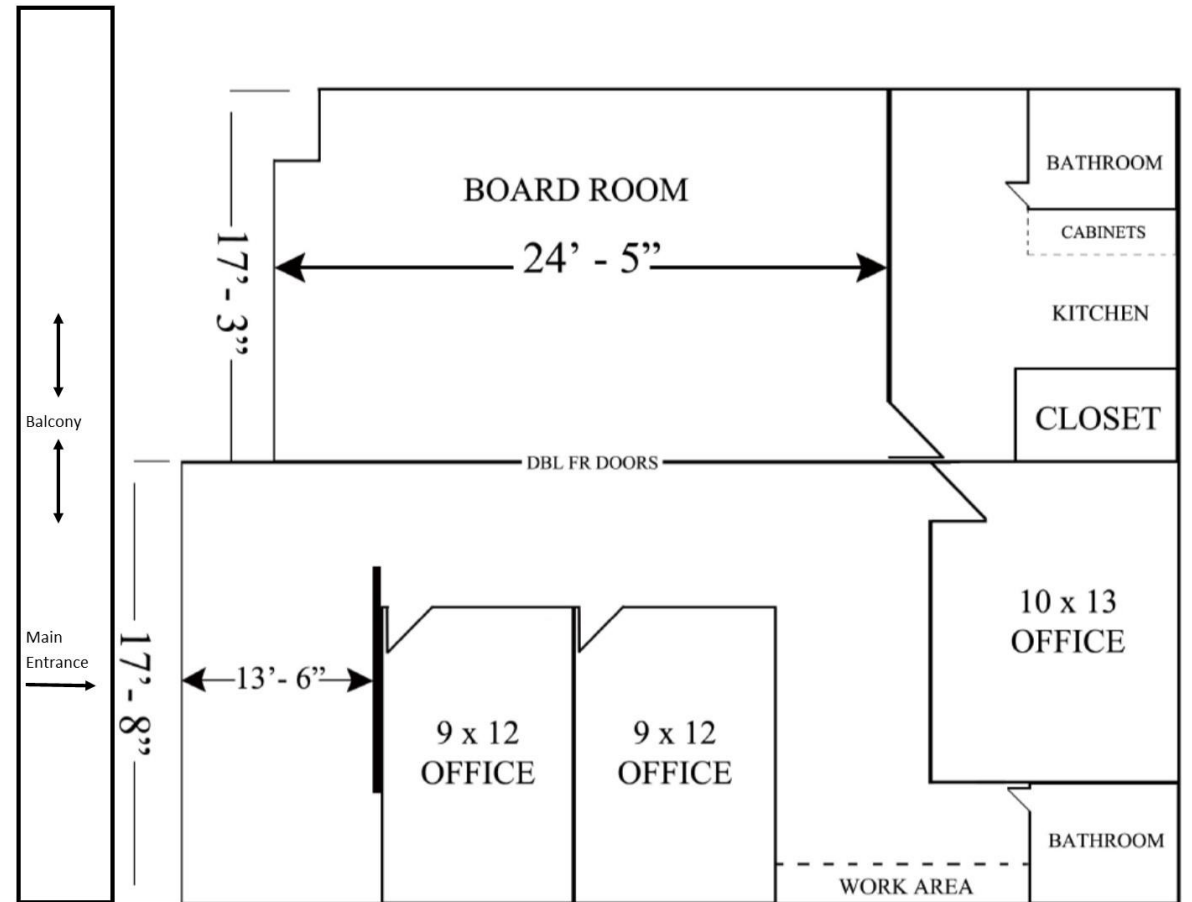

INVEST NOW & COUNTDOWN TO COMPLETION

In addition to the growing benefits of membership, the Chamber offers Building Sponsorships.

BOARD ROOM \$10,000/ 5 years – SOLD!!!

Naming rights, Company signage in room, Recognition online & in all event material, 1 year President's Council Membership, Recognition in The Pelican

VISITOR CENTER \$5,000/ 5 years

Naming rights, Company signage in lobby, Recognition online, Recognition in The Pelican

EXECUTIVE OFFICES \$3,000/ 5 years

Naming rights, Plaque recognition, Recognition online

INKIND DONORS >\$1,000/ 5 years

Unlimited Opportunities, Plaque recognition, Recognition online
(Technology, Moving Services, Plumbing, Building Supplies/ Services, etc.)

PROUD MEMBER



BUILD YOUR BRAND AT THE CHAMBER...

BUILDING SPONSORSHIPS

5 year payment plan

5 year recognition (minimum)

Sponsorships are limited

Contact Angela Hoffman today,

772-546-4724

www.hobesound.org

angela@hobesound.org

